

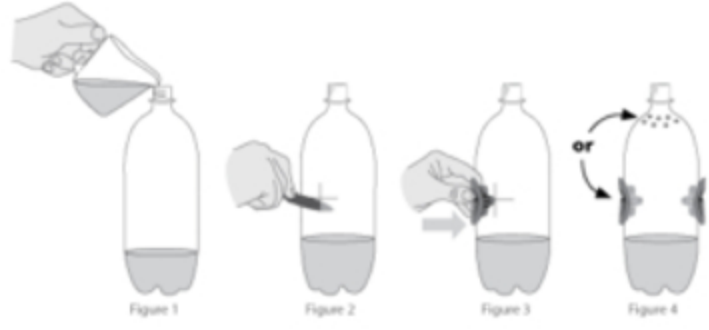

Instructions / Ingredients

Inserting Fatal Funnel in 2-Liter Bottle



1. Add attractant to bottle. Replace cap. (Figure 1)
2. Cut 2" long crosshair opening for funnel above fluid line. (Figure 2)
3. Insert funnel into cut. Work funnel side to side to tighten funnel against bottle. (Figure 3)
4. For best results, add a second funnel on opposite side of bottle or poke small holes on top of bottle. (Figure 4)

Placement of Traps

- Place or hang traps in problem areas, where you have noticed wasps or flies.
- Place trap where there is air movement, but not strong wind.
- For wasp traps, place traps within 20 feet of wasp nests.

Other Tips / Hints

- Set out several traps for more effective trapping.
- Replace 2-liter bottle and attractant when the trap is full or attractant dries up, every 2 to 3 weeks.
- The success of the trap depends on ventilating the attractant.
- Use caution when cutting container. Cut away from your body.
- Use caution when placing and maintaining traps. To reduce risk of stings, place and maintain wasp traps in late evening or early morning when wasps are less active.
- People allergic to wasp stings should allow others to place and maintain traps. Wasp stings can be fatal.

Attractant Recipes

Wasp Trap Recipe	Fly Trap Recipes
<ul style="list-style-type: none"> • 2 Cups of Apple Juice • 1/4 Cup Sugar • Add several pieces of fish, raw meat or cat food 	<ul style="list-style-type: none"> • 2 Cups water • 1 Cup sugar • 1/2 sliced banana, or peel <p>or</p> <ul style="list-style-type: none"> • 2 Cups water • 1/2 Cup syrup <p>or</p> <ul style="list-style-type: none"> • 2 Cups water • 2/4 Cup raw meat <p><i>Note: Allow 2-7 Days for the attractant to become active</i></p>